

| | |
|--------------------------------------------|--------------------------------------------------------------------------------------|
| Dimensionamento <i>Design</i> | ASME B16.34 / EN 12569 / API 608 / EN 17292 ASME VIII DIV.1 / EN 12516-1 |
| Estremità flangiate <i>Flanged ends</i> | ASME B16.5 Cl.150 / 300 EN 1092-1 PN 10/16/25/40 DIN 2632 / 2633 / 2634 / 2635 |
| Collaudo <i>Testing</i> | ASME B16.104 API 598 EN 12266-I ISO 5208 BS 6755-I |

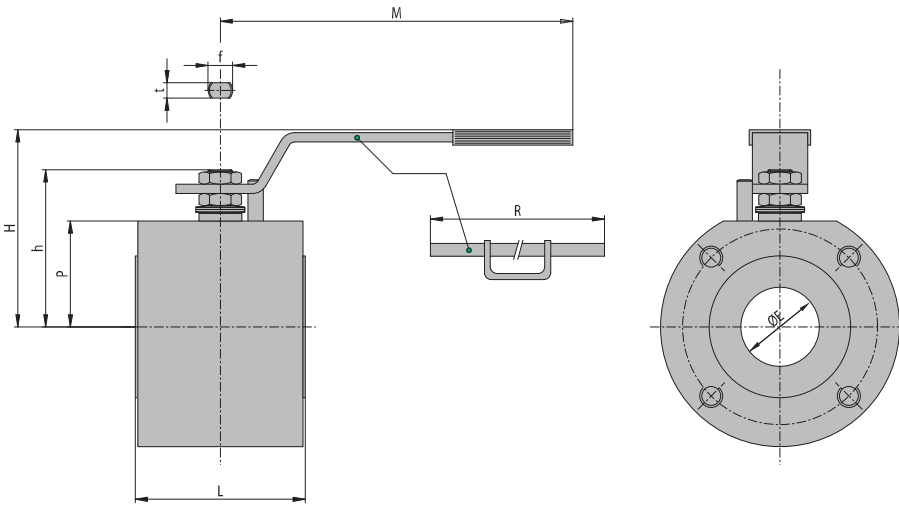

Dimensioni - outline dimensions

| DN | 15 | 20 | 25 | 32 | 40 | 50 | 65 | 80 | 100 | 150 |
|---------|------|------|------|--------|--------|-------|--------|-------|-------|------------------|
| Ø" | 1/2" | 3/4" | 1" | 1 1/4" | 1 1/2" | 2" | 2 1/2" | 3" | 4" | 6" |
| ØE | 14 | 19 | 24 | 29 | 38 | 48 | 64 | 76 | 95 | 152 |
| L | 36 | 39 | 43 | 51 | 63 | 83 | 120 | 120 | 152 | 243/255* |
| M | 145 | 145 | 180 | 180 | 275 | 275 | 380 | 380 | 440 | — ⁽¹⁾ |
| R | — | — | — | — | — | — | — | — | 500 | 800 |
| H | 64 | 66 | 85 | 90 | 118 | 126 | 139 | 144 | 200 | 265 |
| h | 52 | 55 | 70 | 73 | 96 | 101 | 122 | 128 | 157 | 220 |
| P | 33 | 36 | 43 | 48 | 63 | 68.5 | 82 | 88.5 | 111 | 145 |
| F/t | 10/6 | 10/6 | 12/8 | 12/8 | 16/10 | 16/10 | 22/14 | 22/14 | 30/18 | 45/30 |
| Kg | 1.5 | 2 | 2.7 | 4 | 6.5 | 9 | 16 | 20.5 | 42 | 80 |
| ISO5211 | F03 | F03 | F03 | F03 | F05 | F05 | F07 | F07 | F10 | F14 |

* PN25-40/ASME 300 RF

⁽¹⁾ È raccomandato riduttore manuale - *Manual gear recommended*

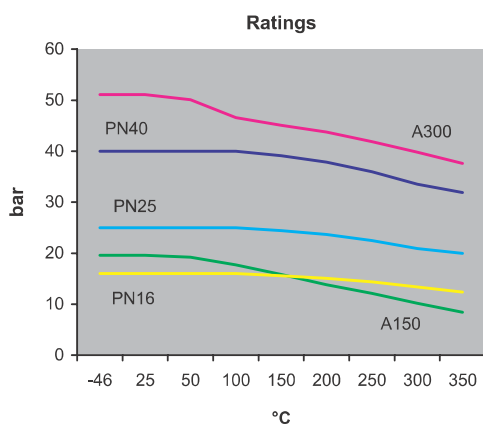

VALVOLE A SFERA FLOTTANTE A SEGGI METALLICI

METAL SEATED FLOATING BALL VALVES



UNI-DIRECTIONAL

-46 °C +400 °C

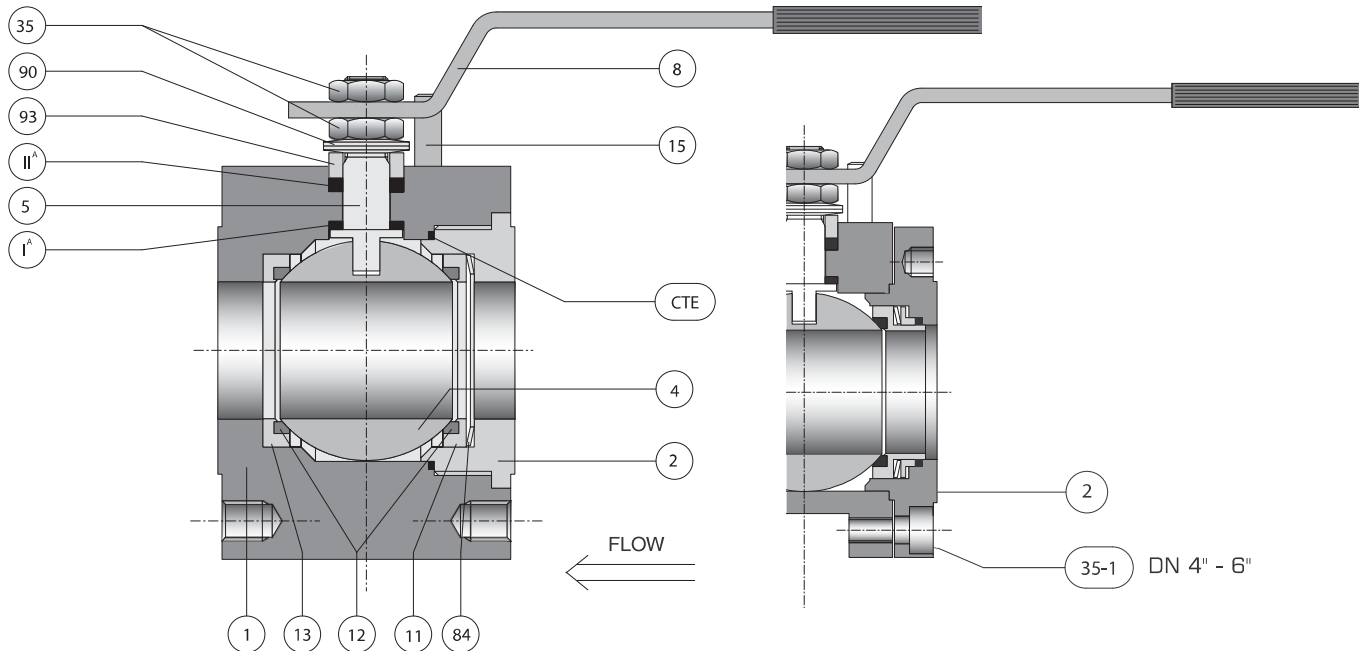

Materiali base - base materials

| | | | | | |
|-----------------|----------------------------|-----------------------|----------------------------|----------------------------|----------------------------|
| CTE | Guarn. Corpo/Terminale | Body connector gasket | Grafoil | Grafoil | Grafoil |
| II ^A | Guarnizione Secondaria | Secondary Stem seal | Grafoil | Grafoil | Grafoil |
| I ^A | Guarnizione Primaria | Primary stem seal | Grafoil | Grafoil | Grafoil |
| 93 | Premi Baderna | Gland | 304SS | 304SS | 304SS |
| 90 | Molle Stelo | Stem spring | UNS S30100 | UNS S30100 | UNS S30100 |
| 84 | Molle Seggio | Seat spring | UNS S30100 | UNS S30100 | UNS S30100 |
| 80 | Leva | Handle | Fe37 UNI 7070 | Fe37 UNI 7070 | Fe37 UNI 7070 |
| 35-1 | Bulloneria Corpo/Terminale | Body/Connector Bolts | 304 S.S. | 304 S.S. | 304 S.S. |
| 35 | Dadi Stelo | Nut | 304 S.S. | 304 S.S. | 304 S.S. |
| 15 | Fermo Leva | Lever stopper | UNI 3740 Gr. 8.8 | UNI 3740 Gr. 8.8 | UNI 3740 Gr. 8.8 |
| 13 | Cassetto Corpo | Body seat holder | A479 Tp.316 | A479 Tp.316 | A479 Tp.316 |
| 12 | Seggio | Seat | PENTAFITE ST6 WC/CRC | PENTAFITE ST6 WC/CRC | PENTAFITE ST6 WC/CRC |
| 11 | Cassetto Terminale | Connector seat holder | A479 Tp.316 | A479 Tp.316 | A479 Tp.316. |
| 5 | Stelo | Stem | 13% Cr. A564 Tp. 630 | A564 Tp. 630 (17/4PH) | A564 Tp. 630 (17/4PH) |
| Riporto Sfera | | Ball coating | HTC/HCR ST6 WC/CRC | HTC/HCR ST6 WC/CRC | HTC/HCR ST6 WC/CRC |
| 4 | Sfera | Ball | 316 S.S. | Tp.316 S.S. | 316 S.S. |
| 2 | Terminale | Connector | A105 | A479 Tp.304 | A479 Tp.316/A351 CF8M |
| 1 | Corpo | Body | A105/A216 WCB | A479 Tp.304/A351 CF8 | A479 Tp.316/A351 CF8M |

P. No. Parte - Part Name

Materiale - Material

Altri materiali disponibili su richiesta - Other materials are available on request



| | |
|--------------------------------------------|--------------------------------------------------------------------------------------|
| Dimensionamento <i>Design</i> | ASME B16.34 / EN 12569 / API 608 / EN 17292 ASME VIII DIV.1 / EN 12516-1 |
| Estremità flangiate <i>Flanged ends</i> | ASME B16.5 Cl.150 / 300 EN 1092-1 PN 10/16/25/40 DIN 2632 / 2633 / 2634 / 2635 |
| Collaudo <i>Testing</i> | ASME B16.104 API 598 EN 12266-I ISO 5208 BS 6755-I |

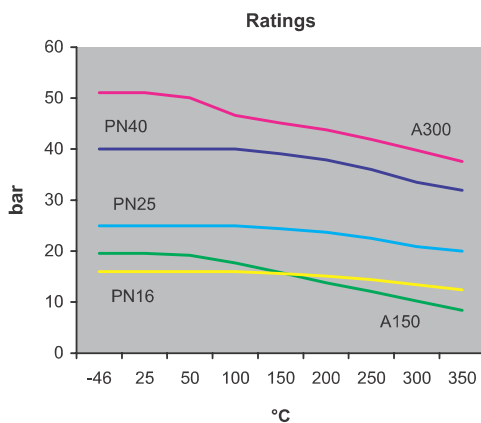
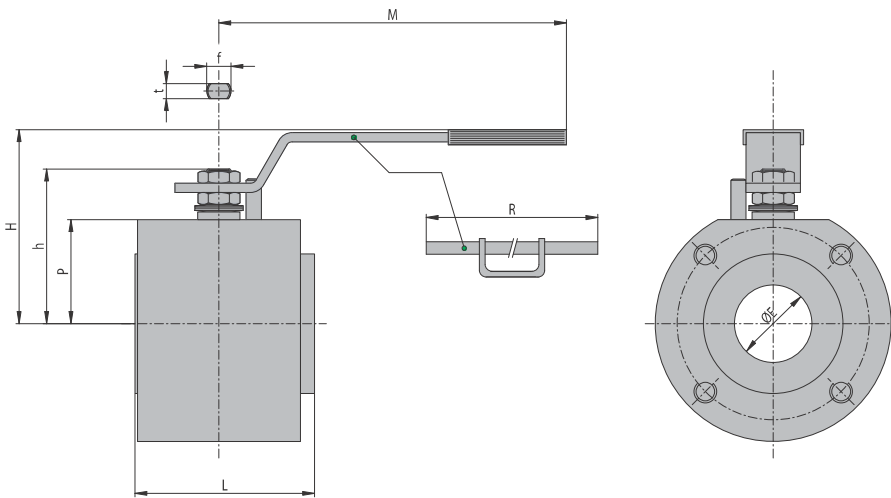

Dimensioni - outline dimensions

| DN | 15 | 20 | 25 | 32 | 40 | 50 | 65 | 80 | 100 | 150 |
|---------|------|------|------|--------|--------|-------|--------|-------|-------|------------------|
| Ø" | 1/2" | 3/4" | 1" | 1 1/4" | 1 1/2" | 2" | 2 1/2" | 3" | 4" | 6" |
| ØE | 14 | 19 | 24 | 29 | 38 | 48 | 64 | 76 | 95 | 152 |
| L | 45 | 50 | 56 | 60 | 75 | 91 | 120 | 127 | 152 | 243/255* |
| M | 145 | 145 | 180 | 180 | 275 | 275 | 380 | 380 | 440 | — ⁽¹⁾ |
| R | — | — | — | — | — | — | — | — | 500 | 800 |
| H | 64 | 66 | 85 | 90 | 118 | 126 | 139 | 144 | 200 | 265 |
| h | 52 | 55 | 70 | 73 | 96 | 101 | 122 | 128 | 157 | 220 |
| P | 33 | 36 | 43 | 48 | 63 | 68.5 | 82 | 88.5 | 111 | 145 |
| F/t | 10/6 | 10/6 | 12/8 | 12/8 | 16/10 | 16/10 | 22/14 | 22/14 | 30/18 | 45/30 |
| Kg | 1.5 | 2 | 2.7 | 4 | 6.5 | 9 | 16 | 20.5 | 42 | 80 |
| ISO5211 | F03 | F03 | F03 | F03 | F05 | F05 | F07 | F07 | F10 | F14 |

* PN25-40/ASME 300 RF

⁽¹⁾ È raccomandato riduttore manuale - *Manual gear recommended*

VALVOLE A SFERA FLOTTANTE A SEGGI METALLICI

METAL SEATED FLOATING BALL VALVES



BI-DIRECTIONAL

-46 °C +400 °C

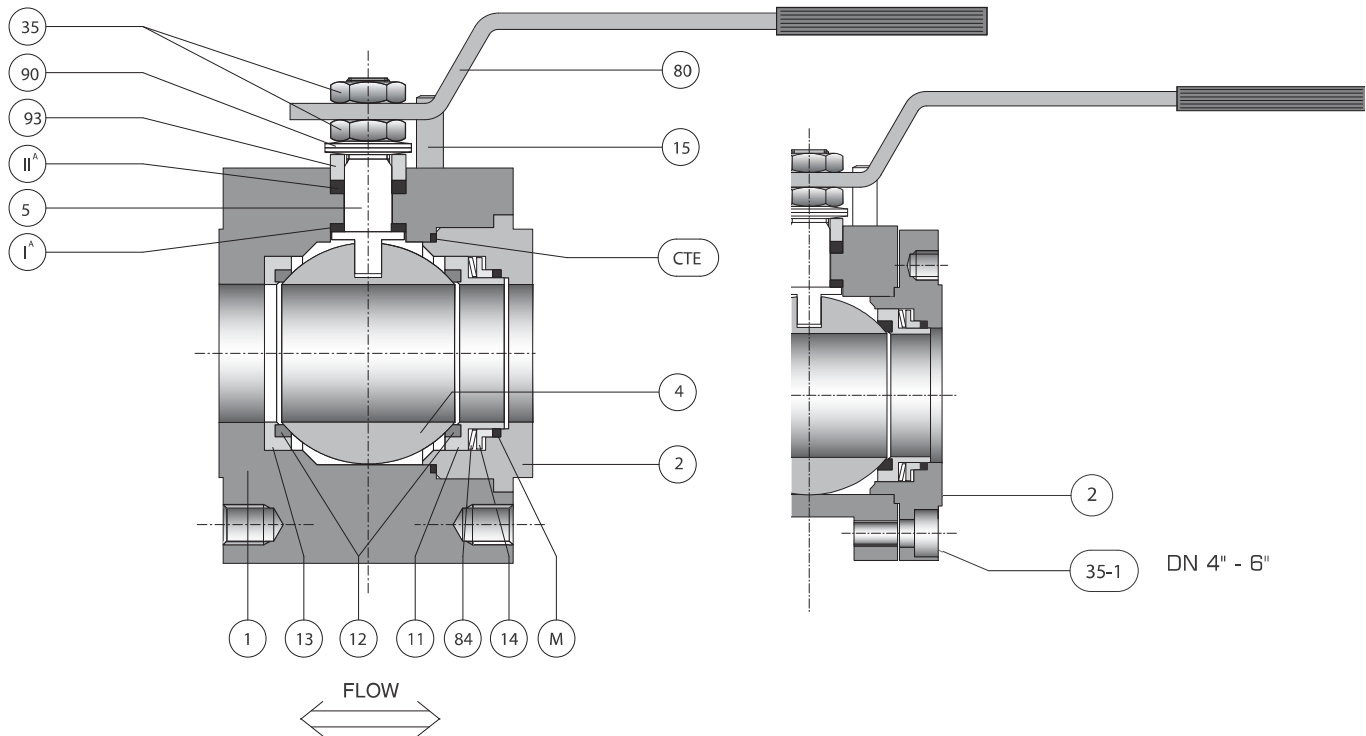

Materiali base - base materials

| | | | | | |
|-----------------|----------------------------|-----------------------|---------------------------------|----------------------------|----------------------------|
| CTE | Guarn. Corpo/Terminale | Body connector gasket | Grafoil | Grafoil | Grafoil |
| M | Guarn. Retroseggio | Backseat gasket | Grafoil | Grafoil | Grafoil |
| II ^A | Guarnizione Secondaria | Secondary Stem seal | Grafoil | Grafoil | Grafoil |
| I ^A | Guarnizione Primaria | Primary stem seal | Grafoil | Grafoil | Grafoil |
| 93 | Premi Baderna | Gland | 304SS | 304SS | 304SS |
| 90 | Molle Stelo | Stem spring | UNS S30100 | UNS S30100 | UNS S30100 |
| 84 | Molle Seggio | Seat spring | UNS S30100 | UNS S30100 | UNS S30100 |
| 80 | Leva | Handle | Fe37 UNI 7070 | Fe37 UNI 7070 | Fe37 UNI 7070 |
| 35-1 | Bulloneria Corpo/Terminale | Body/Connector Bolts | 304 S.S. | 304 S.S. | 304 S.S. |
| 35 | Dadi Stelo | Nut | 304 S.S. | 304 S.S. | 304 S.S. |
| 15 | Fermo Leva | Lever stopper | UNI 3740 Gr. 8,8 | UNI 3740 Gr. 8,8 | UNI 3740 Gr. 8,8 |
| 14 | Premigrafoil | Compression ring | A479 Tp.316 | A479 Tp.316 | A479 Tp.316 |
| 13 | Cassetto Corpo | Body seat holder | A479 Tp.316 | A479 Tp.316 | A479 Tp.316 |
| 12 | Seggio | Seat | PENTAFITE ST6 WC/CRC | PENTAFITE ST6 WC/CRC | PENTAFITE ST6 WC/CRC |
| 11 | Cassetto Terminale | Connector seat holder | A479 Tp.316 | A479 Tp.316 | A479 Tp.316. |
| 5 | Stelo | Stem | 13% Cr. A564 Tp.630 (17/4PH) | A564 Tp.630 (17/4PH) | A564 Tp.630 (17/4PH) |
| - | Riporto Sfera | Ball coating | HTC/HCR ST6 WC/CRC | HTC/HCR ST6 WC/CRC | HTC/HCR ST6 WC/CRC |
| 4 | Sfera | Ball | 316 S.S. | 316 S.S. | 316 S.S. |
| 2 | Terminale | Connector | A105 | A479 Tp.304 | A479 Tp.316/A351 CF8M |
| 1 | Corpo | Body | A105/A216 WCB | A479 Tp.304/A351 CF8 | A479 Tp.316/A351 CF8M |

P. No. Parte - Part Name

Materiale - Material

Altri materiali disponibili su richiesta - Other materials are available on request

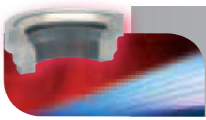

AP10HP

BI-DIREZIONALI

| | |
|--------------------------------------------|--------------------------------------------------------------------------------------|
| Dimensionamento <i>Design</i> | ASME B16.34 / EN 12569 / API 608 / EN 17292 ASME VIII DIV.1 / EN 12516-1 |
| Estremità flangiate <i>Flanged ends</i> | ASME B16.5 CL.600 / 900 EN 1092-1 PN 100 DIN 2637 (PN 100) / DIN 2638 (PN 160) |
| Collaudo <i>Testing</i> | ASME B16.104 API 598 EN 12266-I ISO 5208 BS 6755-I |

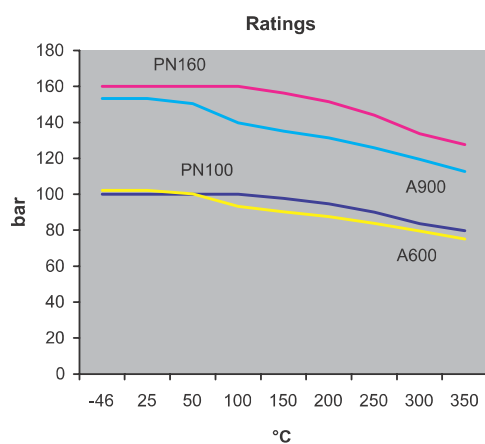
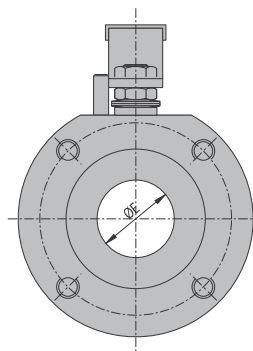
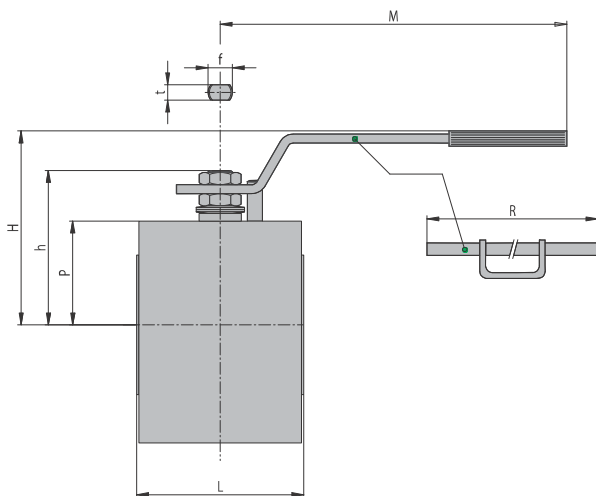

Dimensioni - outline dimensions

| DN | 15 | 20 | 25 | 32 | 40 | 50 | 65 | 80 |
|---------|------|--------|--------|--------|---------|-------|--------|-------|
| Ø" | 1/2" | 3/4" | 1" | 1 1/4" | 1 1/2" | 2" | 2 1/2" | 3" |
| ØE | 14 | 19 | 24 | 29 | 38 | 48 | 64 | 76 |
| L | 55 | 60/75* | 65/74* | 75 | 85/100* | 100 | 125 | 150 |
| M | 145 | 145 | 275 | 275 | 380 | 380 | 440 | 440 |
| R | — | — | — | — | — | — | 500 | 500 |
| H | 65 | 68 | 105 | 115 | 127 | 135 | 160 | 180 |
| h | 53 | 55/70* | 15 | 73 | 105 | 110 | 122 | 142 |
| P | 33 | 36/46* | 51 | 53 | 65 | 15 | 93 | 98 |
| F/t | 10/6 | 10/6 | 16/10 | 16/10 | 22/14 | 22/14 | 30/18 | 30/18 |
| Kg | 2.5 | 3.5 | 4.8 | 6.5 | 10 | 13.5 | 25 | 40 |
| ISO5211 | F03 | F03 | F05 | F05 | F07 | F07 | F10 | F10 |

* PN 160/900RF

VALVOLE A SFERA FLOTTANTE A SEGGI METALLICI

METAL SEATED FLOATING BALL VALVES



AP

BI-DIRECTIONAL

-46 °C +400 °C

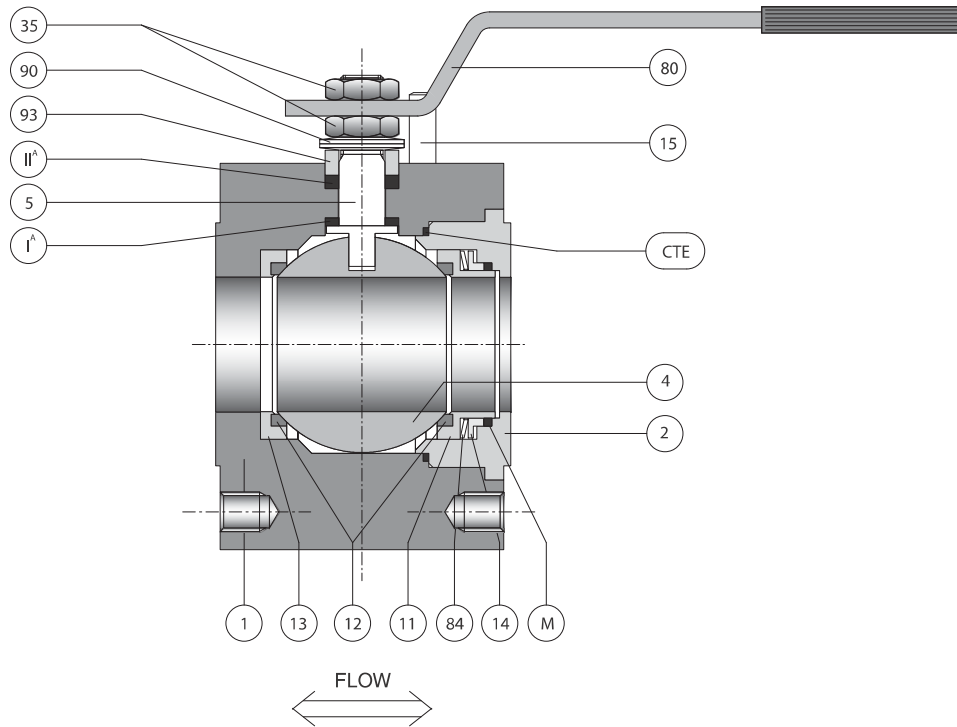

Materiali base - base materials

| | | | | | |
|-----------------|------------------------|------------------------------|----------------------------|----------------------------|----------------------------|
| CTE | Guarn. Corpo/Terminale | <i>Body connector gasket</i> | Grafoil | Grafoil | Grafoil |
| M | Guarn. Retroseggio | <i>Backseat gasket</i> | Grafoil | Grafoil | Grafoil |
| II ^A | Guarnizione Secondaria | <i>Secondary Stem seal</i> | Grafoil | Grafoil | Grafoil |
| I ^A | Guarnizione Primaria | <i>Primary stem seal</i> | Grafoil | Grafoil | Grafoil |
| 93 | Premi Baderna | <i>Gland</i> | 304 S.S. | 304 S.S. | 304 S.S. |
| 90 | Molle Stelo | <i>Stem spring</i> | UNS S30100 | UNS S30100 | UNS S30100 |
| 84 | Molle Seggio | <i>Seat spring</i> | UNS S30100 | UNS S30100 | UNS S30100 |
| 80 | Leva | <i>Handle</i> | Fe37 UNI 7070 | Fe37 UNI 7070 | Fe37 UNI 7070 |
| 35 | Dadi Stelo | <i>Nut</i> | 304 S.S. | 304 S.S. | 304 S.S. |
| 15 | Fermo Leva | <i>Lever stopper</i> | UNI 3740 Gr. 8.8 | UNI 3740 Gr. 8.8 | UNI 3740 Gr. 8.8 |
| 14 | Premigrafoil | <i>Compression ring</i> | A479 Tp.316 | A479 Tp.316 | A479 Tp.316 |
| 13 | Cassetto Corpo | <i>Body seat holder</i> | A479 Tp.316 | A479 Tp.316 | A479 Tp.316 |
| 12 | Seggio | <i>Seat</i> | PENTAFITE ST6 WC/CRC | PENTAFITE ST6 WC/CRC | PENTAFITE ST6 WC/CRC |
| 11 | Cassetto Terminale | <i>Connector seat holder</i> | A479 Tp.316 | A479 Tp.316 | A479 Tp.316 |
| 5 | Stelo | <i>Stem</i> | 13%Cr, A564 Tp.630 | A564 Tp.630 (17/4PH) | A564 Tp.630 (17/4PH) |
| - | Riporto Sfera | <i>Ball coating</i> | HTC/HCR ST6 WC/CRC | HTC/HCR ST6 WC/CRC | HTC/HCR ST6 WC/CRC |
| 4 | Sfera | <i>Ball</i> | 316 S.S. | 316 S.S. | 316 S.S. |
| 2 | Terminale | <i>Connector</i> | A105 | A479 Tp.304 | A479 Tp.316/A351 CF8M |
| 1 | Corpo | <i>Body</i> | A105/A216 WCB | A479 Tp.304/A351 CF8 | A479 Tp.316/A351 CF8M |

P. No. Parte - Part Name

Materiale - Material

Altri materiali disponibili su richiesta - Other materials are available on request

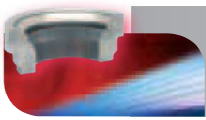

| | |
|-----------------------------------------------------|-----------------------------------------------------------------------------|
| Dimensionamenti - valvola <i>Design - valve</i> | ASME B16.34 / EN 12569 / API 608 / EN 17292 ASME VIII DIV.1 / EN 12516-1 |
| Dimensionamenti - camicia <i>Design - jacket</i> | ASME VIII DIV.1 |
| Estremità flangiate <i>Flanged ends</i> | ASME B16.5 CL. 150 / 300 / 600 EN 1092-1 PN 10/16/25/40/100 |
| Attacchi camicia <i>Jacket connections</i> | SW / NPT CL. 150 RF PN 10/16 |
| Collaudo <i>Testing</i> | ASME B16.104 API 598 EN 12266-1 ISO 5208 BS 6755-1 |

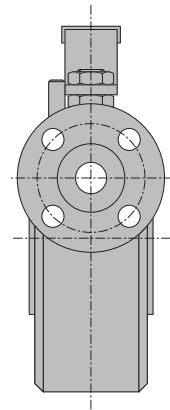
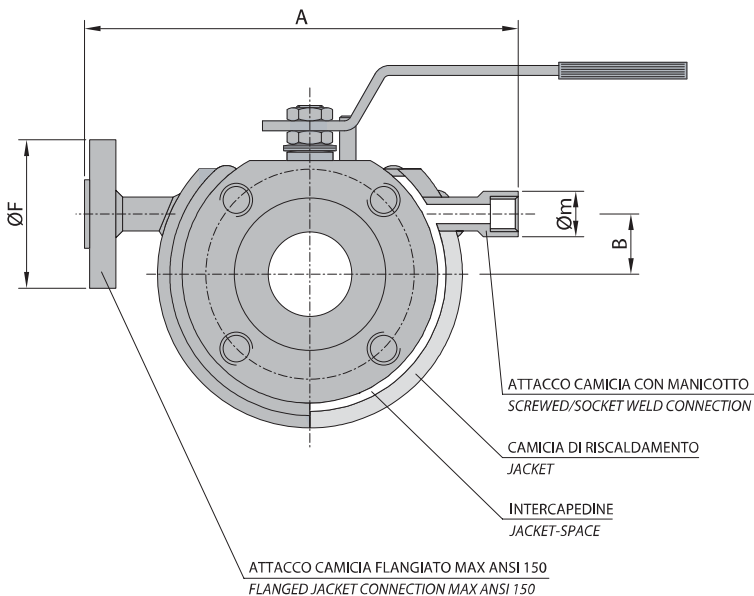

| Dimensioni - outline dimensions | | | | | | | | | |
|---------------------------------|--------|------|-----|--------|-----|--------|-----|-------|-----|
| DN | 15 | 20 | 25 | 40 | 50 | 65 | 80 | 100 | 150 |
| Ø" | 1/2" | 3/4" | 1" | 1 1/2" | 2" | 2 1/2" | 3" | 4" | 6" |
| A | 160 | 160 | 190 | 230 | 250 | 270 | 300 | 340 | 420 |
| B | 0 | 0 | 0 | 30 | 30 | 45 | 50 | 70 | 95 |
| ØF | DN 15 | | | | | | | DN 25 | |
| Øm | Ø 1/2" | | | | | | | Ø 1" | |
| Kg | 3 | 3.5 | 4.5 | 9 | 11 | 20 | 25 | 40 | 80 |

VALVOLE A SFERA FLOTTANTE A SEGGI METALLICI INCAMICIATA

METAL SEATED FLOATING BALL VALVES C/W JACKET



AP

-46 °C +400 °C

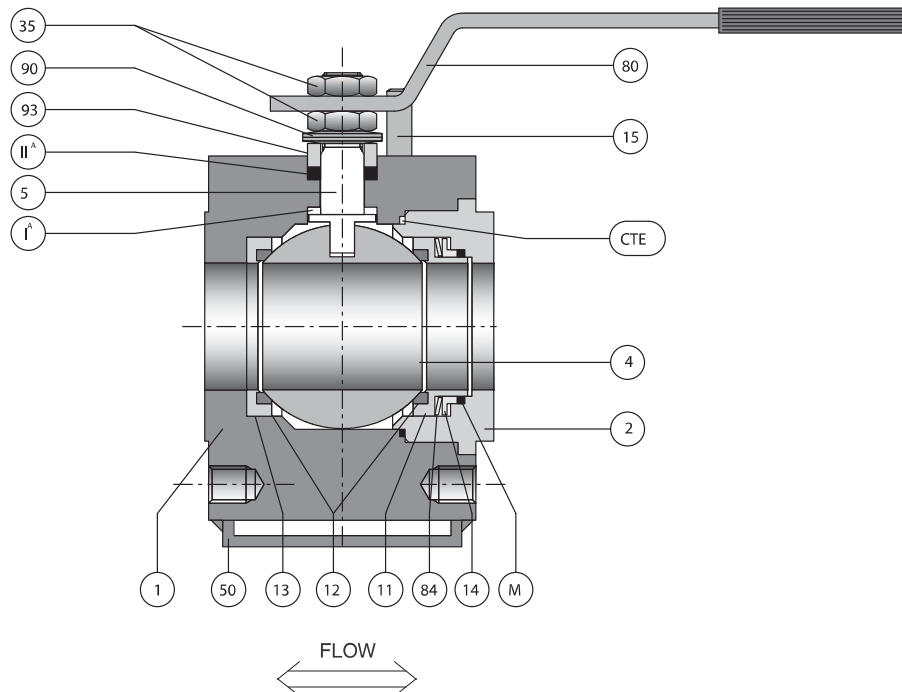

Materiali base - base materials

| | | | | | |
|-----------------|------------------------|-----------------------|---------------------------------|----------------------------|----------------------------|
| CTE | Guarn. Corpo/Terminale | Body connector gasket | Grafoil | Grafoil | Grafoil |
| M | Guarn. Retroseggio | Backseat gasket | Grafoil | Grafoil | Grafoil |
| II ^A | Guarnizione Secondaria | Secondary Stem seal | Grafoil | Grafoil | Grafoil |
| I ^A | Guarnizione Primaria | Primary stem seal | Grafoil | Grafoil | Grafoil |
| 93 | Premi Baderna | Gland | 304 S.S. | 304 S.S. | 304 S.S. |
| 90 | Molle Stelo | Stem spring | UNS S30100 | UNS S30100 | UNS S30100 |
| 84 | Molle Seggio | Seat spring | UNS S30100 | UNS S30100 | UNS S30100 |
| 80 | Leva | Handle | Fe37 UNI 7070 | Fe37 UNI 7070 | Fe37 UNI 7070 |
| 50 | Camicia riscaldamento | Heating jacket | A105 | 304 S.S. | 304 S.S. |
| 35 | Dadi Stelo | Nut | 304 S.S. | 304 S.S. | 304 S.S. |
| 15 | Fermo Leva | Lever stopper | UNI 3740 Gr. 8,8 | UNI 3740 Gr. 8,8 | UNI 3740 Gr. 8,8 |
| 14 | Premigrafoil | Compression ring | A479 Tp.316 | A479 Tp.316 | A479 Tp.316 |
| 13 | Cassetto Corpo | Body seat holder | A479 Tp.316 | A479 Tp.316 | A479 Tp.316 |
| 12 | Seggio | Seat | PENTAFITE ST6 WC/CRC | PENTAFITE ST6 WC/CRC | PENTAFITE ST6 WC/CRC |
| 11 | Cassetto Terminale | Connector seat holder | A479 Tp.316 | A479 Tp.316 | A479 Tp.316. |
| 5 | Stelo | Stem | 13% Cr. A564 Tp.630 (17/4PH) | A564 Tp.630 (17/4PH) | A564 Tp.630 (17/4PH) |
| - | Riporto Sfera | Ball coating | HTC/HCR ST6 WC/CRC | HTC/HCR ST6 WC/CRC | HTC/HCR ST6 WC/CRC |
| 4 | Sfera | Ball | A479 Tp.316 | A479 Tp.316 | A479 Tp.316 |
| 2 | Terminale | Connector | A105 | A479 Tp.304 | A479 Tp.316 |
| 1 | Corpo | Body | A105 | A479 Tp.304 | A479 Tp.316 |

P. No. Parte - Part Name **Materiale - Material**

Altri materiali disponibili su richiesta - Other materials are available on request

HTC = Nitruri di Titanio (Titanium Nitrides); HCR = Nitruri di Cromo (Chrome Nitrides); ST6 = Stellite 6 Detonation Gun/HVOF
WC = Carburi di Tungsteno (Tungsten Carbides Detonation Gun/HVOF); CRC = Carburi di Cromo (Chrome Carbides Detonation Gun/HVOF)