



Vinco  
VALVES



## **INDEX**

*COMPANY*

*APPLICATION*

*INDUSTRIAL*

*METAL SEATED*

*CRYOGENIC*

*SANITARY*

*HYDROGEN*

*SYSTEMS*

*ACCESSORIES*

**COMPANY**





## VINCO VÁLVULAS

We are Vinco, valve manufacturers with over 30 years of experience in the market.

The focus on technological development and the strengthen of its know-how has allowed to expand to new markets being recognized for our ability to develop solutions to fulfill the market demands. As a consequence we have developed in the past years a range of products for **oil & gas, hydrogen, sanitary, chemical and cryogenic industries.**

We have a dedicated team ready to respond to your most demanding requests, knowing that the key word here is the quality of all our products and services. We are responsible for the design, development, assembly and testing under the highest quality standards of all our products.

We are in V.N Famalicão, Portugal and we have a 4.200m<sup>2</sup> modern facilities.





## VINCO TEAM

- EXCELLENCE
- COMPETENCE
- DEDICATION
- PROFESSIONALISM

Continuous improvement culture and  
Customer-Orientation.

# VINCO IN NUMBERS

OUR GOALS



**+50**

EMPLOYEES

**+90%**

EXPORT

**+55**

COUNTRIES

**+30**

YEARS OF ACTIVITY

**50%**

INDUSTRIAL VALVES

**30%**

SANITARY VALVES

**+40**

CERTIFICATES

**+100**

REFERENCES

**+30 000**

No OF VALVES/YEAR



# FACILITIES

GENERAL CONSTRUCTION



- CNC turning machine up to Ø800;
- CNC machining centers up to Ø1000mm (new machine);
- Lapping machine;
- Polishing;
- Electropolishing;
- Painting cabinet;
- Welding facilities.





# QUALITY CONTROL TESTS

RESEARCH, DEVELOPMENT AND ENGINEERING

## NDE

- LPI – Liquid Penetrant Inspection;
- MPI – Magnetic Particle Inspection;
- UST – Ultrasound Test;
- X – Ray (External);
- PMI – Positive Material Identification.

## OTHERS TESTS

- Ra Measurements;
- Boroscope Inspection;
- Anti-corrosive and Impact Tests.

## TESTING

- Hydrostatic and Pneumatic Test;
- Helium Leak Test;
- Cryogenic Test;
- High Pressure Gas Test.

## TYPE TEST

- Fire Safe Test;
- Fugitive Emissions Test;
- Cryogenic Test.







# DESIGN & DEVELOPMENT

RESEARCH, DEVELOPMENT AND ENGINEERING

## RESEARCH AND DEVELOPMENT

- Conception of new products;
- Engineering calculation;
- Design of parts and assembly.

## ENGINEERING

- Valve torque figures;
- Finite Element Analysis;
- Flow analysis simulations.

# CERTIFICATIONS

COMPANY & PRODUCT

vinco  
VALVES



ISO 9001



PED/CE



Firesafe Design  
ISO 10497:2010  
API 607 6 Edition



ATEX Design



TA Luft  
Fugitive Emissions  
ISO 15848



SIL  
IEC 61508

---

COMPANY CERTIFICATIONS

---

PRODUCT CERTIFICATIONS



# WHERE WE ARE

COUNTRIES



PORTUGAL // SPAIN // UNITED KINGDOM // IRELAND // POLAND // SLOVAKIA // SERBIA // CANADA // INDIA // UKRAINE // FRANCE //  
GERMANY // NETHERLANDS // BELGIUM // ROMANIA // AUSTRALIA // HUNGARY // LUXEMBOURG // USA // TURKEY //  
THAILAND // DENMARK // SWEDEN // NORWAY // GREECE // SOUTH KOREA // VIETNAM

# REFERENCES

REFERENCE COMPANIES

Vinco  
VALVES

DIAGEO



AGFA 

Alcatel-Lucent 

**Baxter**

>Bran+Luebbe®

 Schering-Plough



 epicenergy

**dusup**

أرامكو السعودية  
saudi aramco 



janssen 

galp 

Qualiphar

**SAMSUNG**  
BIOLOGICS

 SOLVAY



 MEDI-LINE

 **PETROBRAS**



 **REPSOL**

 SANOFI

Valmet 

Hovione 



**APPLICATION**

# MARKETS



**INDUSTRIAL**

**METAL SEATED**

**CRYOGENIC**

**SANITARY**

**HYDROGEN**



**INDUSTRIAL**

# INDUSTRIAL

## GENERAL CONSTRUCTION

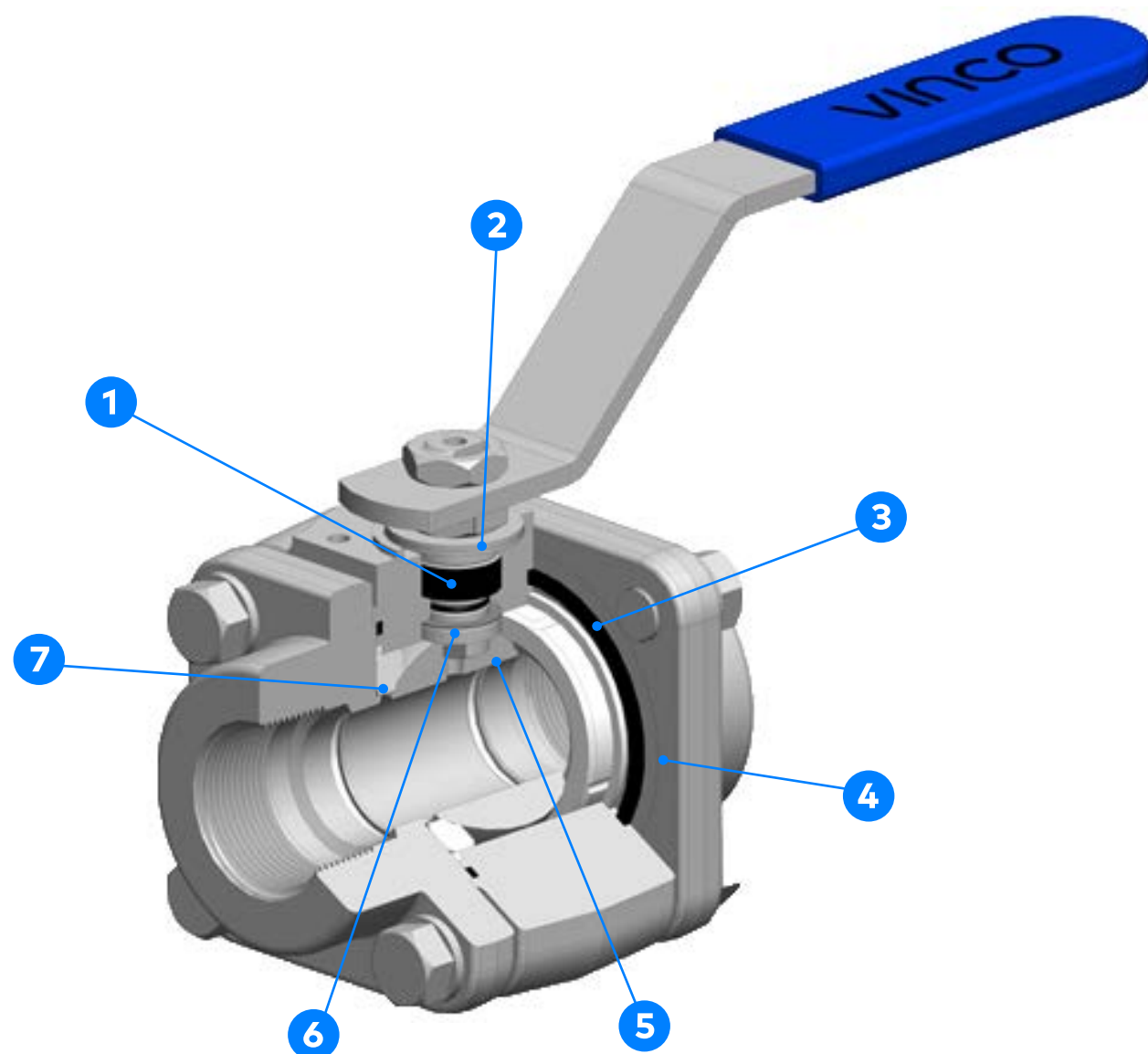

- ① Anti-blowout stem;
- ② Self-adjust live loaded packing system ensures longer service without maintenance and spare parts replacement;
- ③ Body cavity pressure relief when the valve is in the closed position;
- ④ Encapsulated graphite body seals for extra resistance;
- ⑤ Ball relief hole to equalize pressures inside the body when the valve is in the open position;
- ⑥ Electrical conductivity is ensured between body, ends, stem and ball acc. ATEX 2014/34/EU;
- ⑦ Metal backup seat for sealing in the event of a fire.



INDUSTRY



FUGITIVE  
EMISSIONS



ATEX



FIRE SAFE



FLOATING



TRUNNION



CERTIFICATION



## CONSTRUCTION STANDARDS:

API 6D/ ISO 14313 | ASME B16.34  
API 608 | ISO 17292 | MSS-SP-25

## BODY MATERIALS:

A105N-LF2 / A350 LF2 / A216 WCB  
A182 F316-F316L / A479 316-316L  
A351 CF3M / A351 CF8M  
A479 S31803 / A479 S32760  
Others on request

## CONNECTIONS:

### • Threaded Ends

BSP/BSPP – ISO 228-1  
BSPT – ISO 7-1 / EN 10226-1|2  
NPT – ASME B1.20.1

### • Butt weld Ends

BW (Sch.10 to XXS)  
ASME B36.10M and B16.25

### • Nipple Ends

BW (Sch.10 to XXS)  
ASME B36.10M and B16.25  
SW – ASME B16.11

### • Socket weld Ends

SW – ASME B16.11

### • Flanged RF & RTJ

ASME B16.5 and ASME B16.10

# INDUSTRIAL

PRODUCTS - FLOATING

**vinco**  
VALVES



## SF SERIES

3-Piece Bolted – Floating  
Type

Fire Safe – Anti-static

Bar stock / Forged

CL800/600/300

DN 1/2" ÷ 1 1/2"



## HF SERIES

3-Piece Bolted – Floating  
Type

Fire Safe – Anti-static

Bar stock / Forged

CL2500/1500/900

DN 1/2" ÷ 1 1/2"

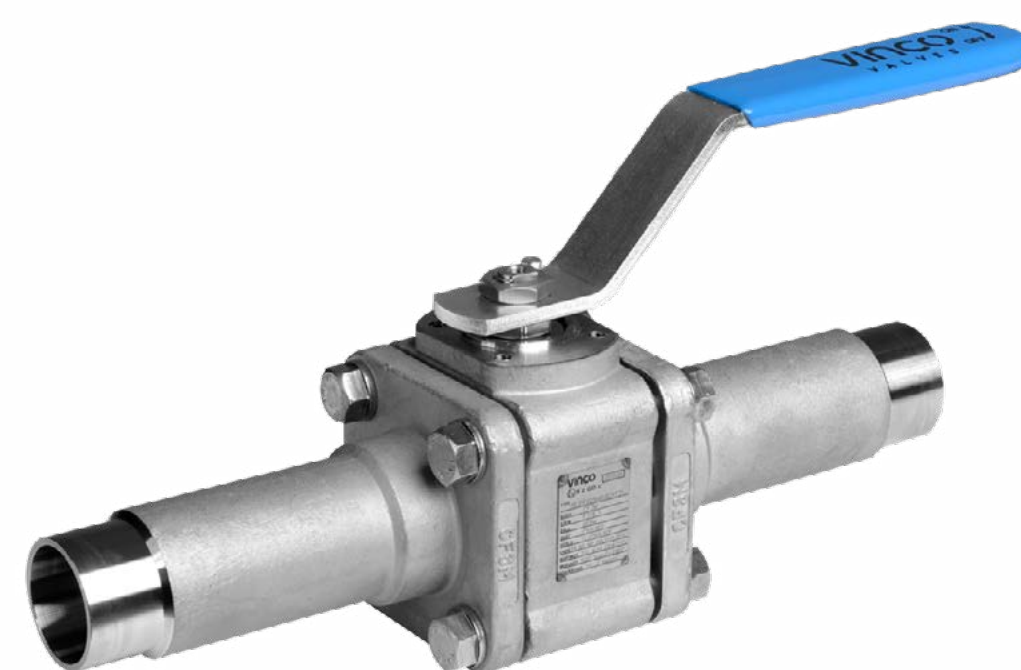

## XF SERIES

3-Piece Bolted – Floating  
Type

Fire Safe – Anti-static

Cast

CL600/400/300

DN 3/8" ÷ 4"



# INDUSTRIAL

PRODUCTS - FLOATING

**vinco**  
VALVES



## CF SERIES

2-Split Body – Floating Type  
Fire Safe – Anti-static  
Cast  
CL150/300 - PN16/40  
DN 1/2" ÷ 8"



## BF SERIES

2-Split Body – Floating Type  
Fire Safe – Anti-static  
Bar stock / Forged  
CL150/300/600 - PN16/40/100  
DN 1/2" ÷ 6"



## QF SERIES

4/5- Piece Bolted – Multiport Type  
Fire Safe – Anti-static  
Cast  
CL150/300/600 - PN16/40/100  
DN 1/2" ÷ 2"

follow us @ f in • [vincovalves.com](http://vincovalves.com)

# INDUSTRIAL

PRODUCTS - TRUNNION

vinco  
VALVES



## VTR SERIES

3 Piece Bolted – Trunnion  
Type  
Fire Safe – Anti-static  
Forged  
CL150 to 2500  
DN 1/2" ÷ 12"



## CTR SERIES

2 Split Body – Trunnion  
Type  
Fire Safe – Anti-static  
Cast  
CL150 to 300  
DN 6" ÷ 12"



# INDUSTRIAL

## PRODUCTS - DOUBLE BLOCK AND BLEED

- Twin Ball valve;
- Isolation, monitoring and sampling processes;
- Sampling valve available with needle or ball valve.

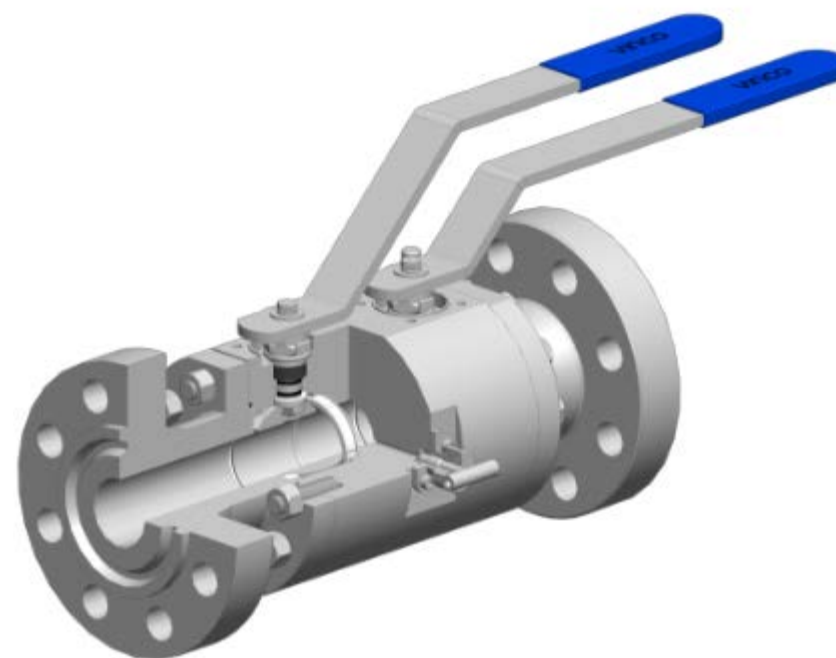

### FLOATING

Ball Type

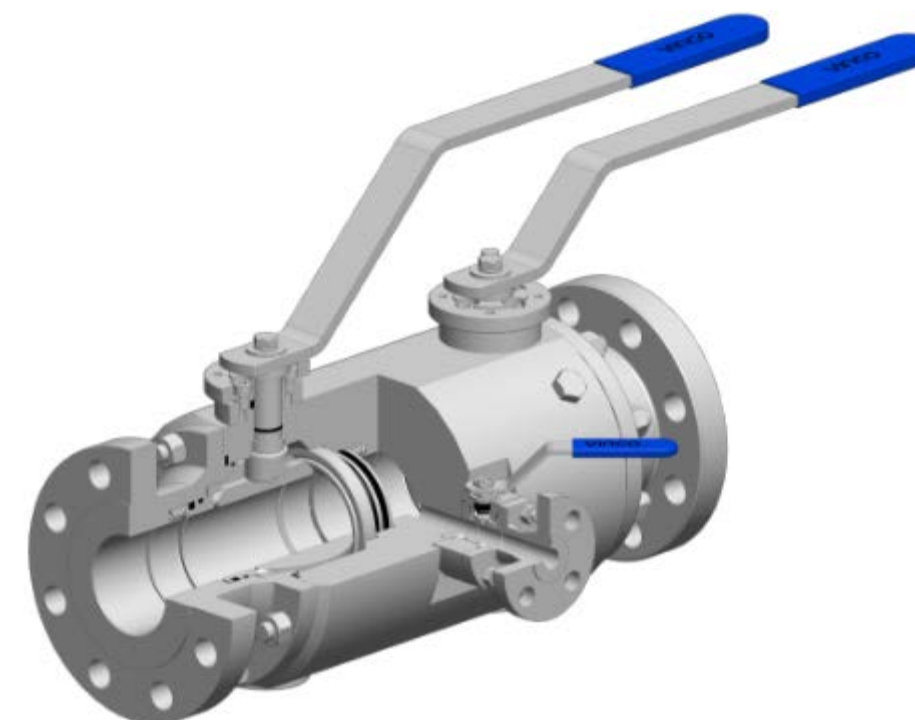

### TRUNNION

Mounted



INDUSTRY



HIGH PRESSURE



FIRE SAFE



FLOATING

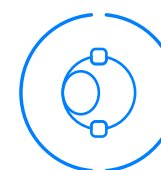

TRUNNION



CERTIFICATION

**METAL SEATED**



# METAL SEATED

## PRODUCTS

### Abrasive media (up to 250°C)

Tungsten Carbide Coating

### High temperature (up to 450°C)

Chromium Carbide Coating

Applied in the contact surfaces of the ball and seats, with a minimum specified thickness of 200 µm, increases the hardness (up to 70 HRC) and the resistance to wearing conditions (abrasion, friction, others). This technology combined with lapping process improves the sealing effect and the operation lifetime expectancy without maintenance under severe working conditions.



METAL SEATED



HIGH PRESSURE



FIRE SAFE

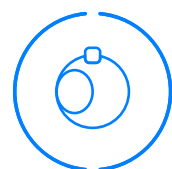

FLOATING

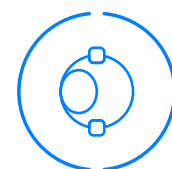

TRUNNION



CERTIFICATION

Vinco  
VALVES

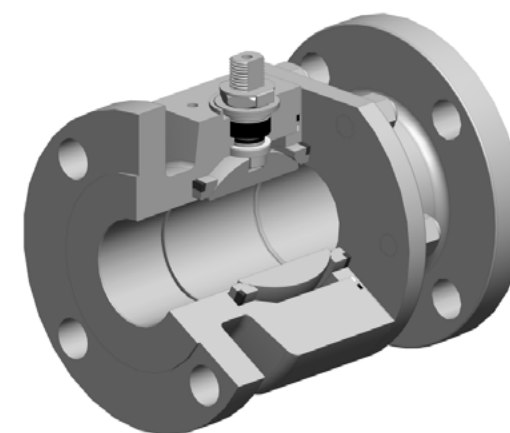

## FLOATING

Ball Type

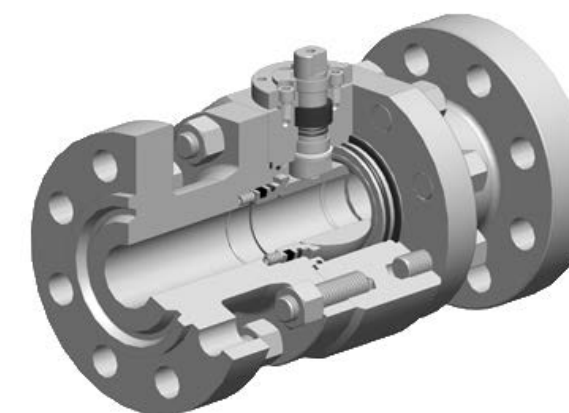

## TRUNNION

Mounted

**CRYOGENIC**

# CRYOGENIC RANGE

## GENERAL CONSTRUCTION

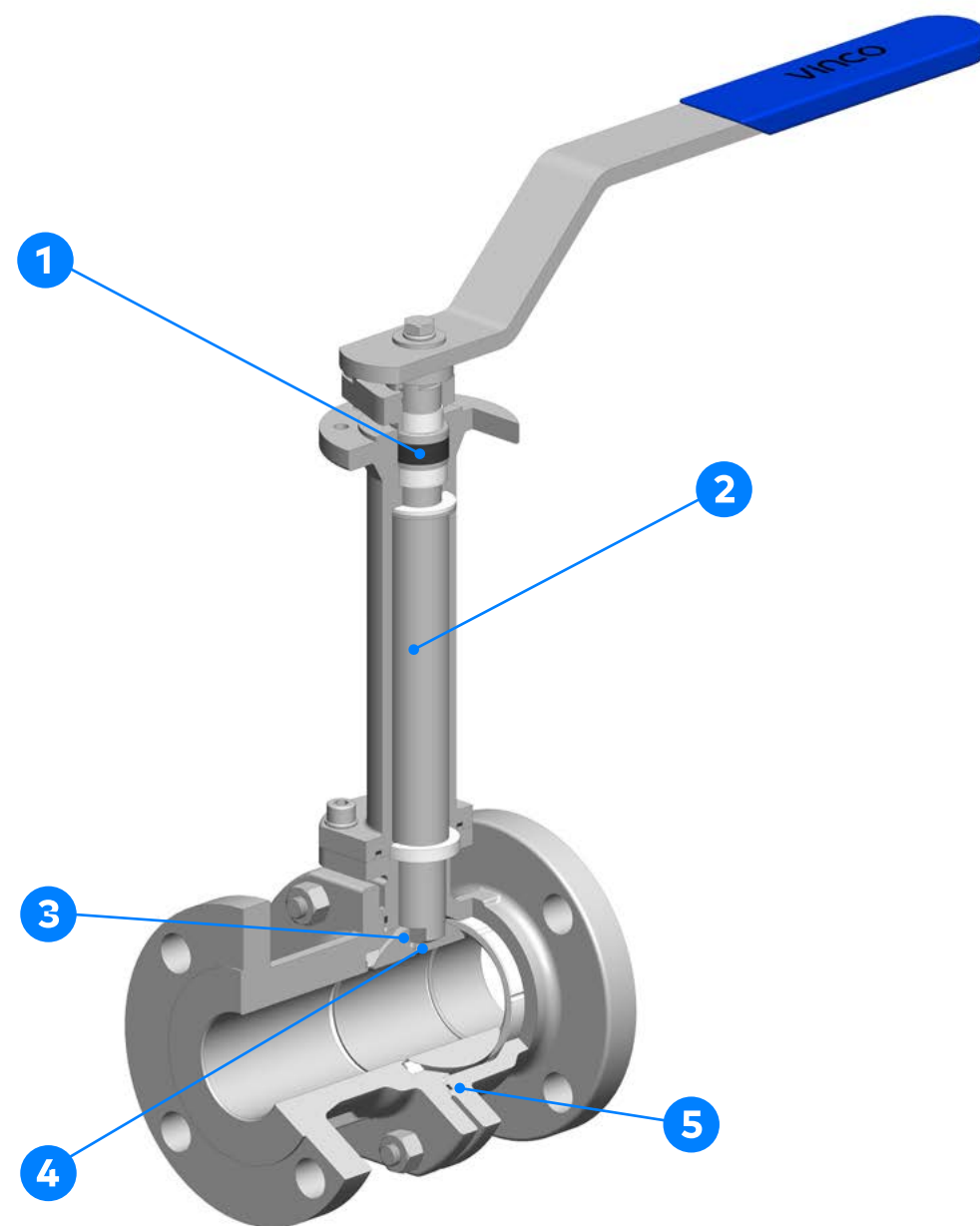

- ① Self-adjust live loaded packing system ensures longer service without maintenance and spare parts replacement;
- ② Room for thermal expansion;
- ③ Electrical conductivity is ensured between body, ends, stem and ball acc. ATEX 2014/34/EU;

- ④ Ball relief hole to equalize pressures inside the body when the valve is in the open position;
- ⑤ Encapsulated graphite body seals for extra resistance.

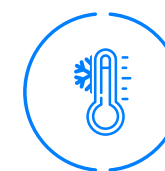

CRYOGENIC



FIRE SAFE

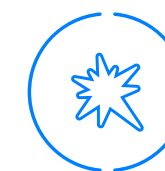

ATEX



FLOATING

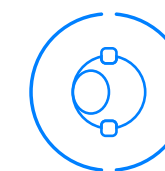

TRUNNION



CERTIFICATION



# CRYOGENIC RANGE

GENERAL CONSTRUCTION

## CONSTRUCTION STANDARDS:

API 6D/ISO 14313 | ASME B16.34

API 608 | ISO 17292 | MSS-SP-25

## BODY MATERIALS:

A182 F316-F316L / A479 316-316L

A351 CF3M / A351 CF8M

A350 LF3

Others on request

## CONNECTIONS:

- Buttweld Ends

BW (Sch.10 to XXS)

ASME B36.10M and B16.25

- Nipple Ends

BW (Sch.10 to XXS)

ASME B36.10M and B16.25

SW – ASME B16.11

- Socketweld Ends

SW – ASME B16.11

- Flanged RF & RTJ

ASME B16.5 and ASME B16.10

# CRYOGENIC RANGE

GENERAL CONSTRUCTION

vinco  
VALVES



## CXF SERIES

3-Piece Bolted  
Floating Type  
Anti-static  
Cast  
CL600/800  
DN  $\frac{3}{8}$ " ÷ 4"



## CCF SERIES

2 Split Body  
Floating Type  
Anti-static  
Cast  
CL150 to 300  
DN  $\frac{1}{2}$ " ÷ 8"

**SANITARY**



# SANITARY

GENERAL CONSTRUCTION

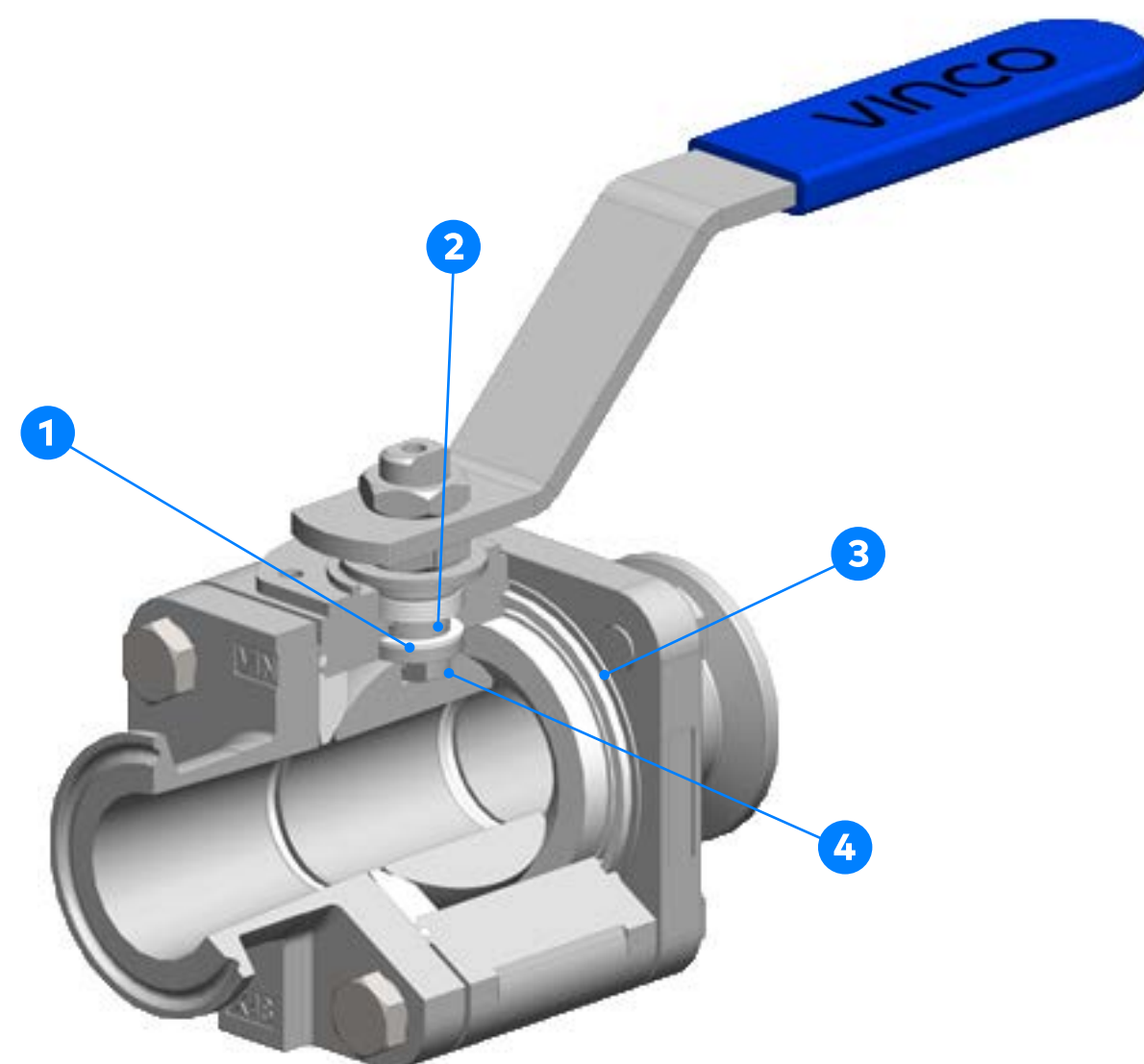

- ① Anti-blowout stem;
- ② Self-adjust live loaded packing system ensures longer service without maintenance and spare parts replacement;
- ③ Encapsulated body seals for extra resistance;
- ④ Electrical conductivity is ensured between body, ends, stem and ball acc. ATEX 2014/34/EU.



SANITARY



PHARMACEUTICAL



FIRE SAFE



FUGITIVE  
EMISSIONS



ATEX



FLOATING



CERTIFICATION

# SANITARY

GENERAL CONSTRUCTION

## CONSTRUCTION STANDARDS

ASME BPE | DIN 11850 | ISO 1127

## BODY MATERIALS

A351 CF3M (max. ferrite 2% ; sulfur 0.005-0.017%)

A182 F316316L

1.4435 BN2

Hastelloy C22 and C276

## CONNECTIONS

- Extended/Orbital Buttweld Ends

- Hygienic Clamp End

ASME BPE TUBE | DIN 11850 TUBE

ISO 1127 TUBE

## SURFACE FINISH

- Interior Mechanical Polishing

Ra of less than 0,50  $\mu\text{m}$  (20 $\mu\text{in}$ ) (SF1)

- Exterior Mechanical Polishing

Ra 0,75 micro polished (30 $\mu\text{in}$ ) (SF3)

- Electro-polishing

Ra 0,38 micrometer (15 $\mu\text{in}$ ) (SF4)



## RP SERIES

3-Piece Bolted  
Anti-static  
Bar stock / Forged  
DN 1/2" ÷ 6"



## XP SERIES

3-Piece Bolted  
Anti-static  
Investment Cast  
DN 1/2" ÷ 6"



## LP SERIES

3-Piece Bolted  
Anti-static  
Investment Cast  
DN 1/2" ÷ 2"



## MP SERIES

Multiways  
Anti-static  
Bar stock / Forged  
DN 1/2" ÷ 2"



## QP SERIES

Multiways  
Anti-static  
Investment Cast  
DN 1/2" ÷ 2"



**HYDROGEN**

# HYDROGEN RANGE

## GENERAL CONSTRUCTION

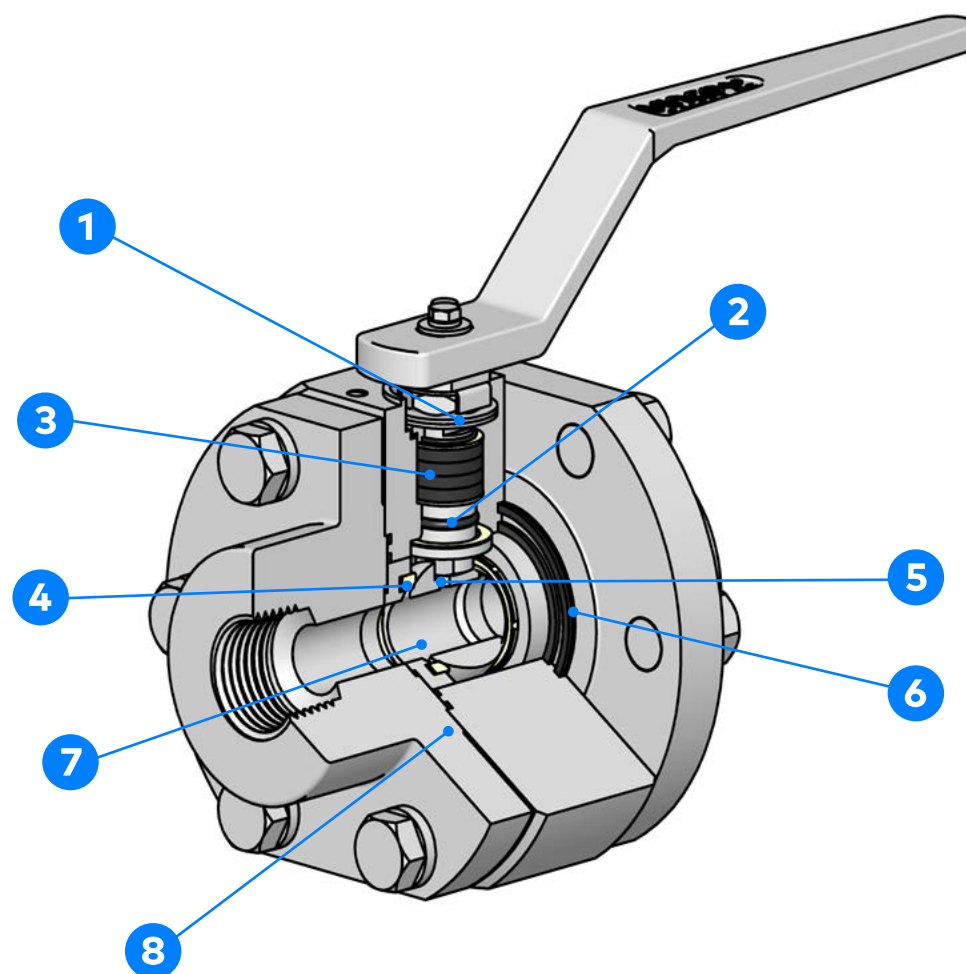

- ① Self-adjust live loaded packing system ensures longer service without maintenance and spare parts replacement;
- ② Anti explosive decompression to ensure low fugitive emissions;
- ③ Electrical conductivity is ensured between body, ends, stem and ball acc. ATEX 2014/34/EU;
- ④ Pressure relieving seats for body cavity with valve in the closed position;
- ⑤ Ball relief hole to equalize pressures inside the body when the valve is in the open position;
- ⑥ Encapsulated graphite body seals for extra resistance;
- ⑦ Metal backup seat for sealing in the event of a fire;
- ⑧ Ball relief hole to equalize pressures inside the body when the valve is in the open position.



HYDROGEN



FIRE SAFE



ATEX



FLOATING

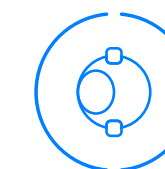

TRUNNION



CERTIFICATION

## CONSTRUCTION STANDARDS:

API 6D/ ISO 14313 | ASME B16.34  
API 608 | ISO 17292 | MSS-SP-25

## BODY MATERIALS:

A105N-LF2 / A350 LF2  
A182 F316-316L / A479 316-316L  
Others on request

## CONNECTIONS:

### • Threaded Ends

BSP/BSPP – ISO 228-1  
BSPT – ISO 7-1 / EN 10226-1|2  
NPT – ASME B1.20.1

### • Buttweld Ends

BW (Sch.10 to XXS)  
ASME B36.10M and B16.25

### • Nipple Ends

BW (Sch.10 to XXS)  
ASME B36.10M and B16.25  
SW – ASME B16.11

### • Socketweld Ends

SW – ASME B16.11

### • Flanged RF & RTJ

ASME B16.5 and ASME B16.10



# HYDROGEN

PRODUCTS - FLOATING

**vinco**  
VALVES



## CFH SERIES

2-Split Body  
Floating Type  
Fire Safe – Anti-static  
Cast  
CL150/300 - PN16/40  
DN 1/2" ÷ 8"



## XFH SERIES

3-Piece Bolted  
Floating Type  
Fire Safe – Anti-static  
Cast  
CL600/400/300  
DN 3/8" ÷ 4"



## SFH SERIES

3-Piece Bolted  
Floating Type  
Fire Safe – Anti-static  
Bar stock / Forged  
CL800  
DN 1/2" ÷ 1 1/2"

# HYDROGEN

PRODUCTS - FLOATING

vinco  
VALVES



## HFH5 SERIES

3-Piece Bolted  
Floating Type  
Fire Safe – Anti-static  
Bar stock / Forged  
CL1500  
DN 1/2" ÷ 1 1/2"



## HFH6 SERIES

3-Piece Bolted  
Floating Type  
Fire Safe – Anti-static  
Bar stock / Forged  
CL2500  
DN 1/2" ÷ 1"



## HFH7 SERIES

3-Piece Bolted  
Floating Type  
Fire Safe – Anti-static  
Bar stock / Forged  
CL4000  
DN 1/2" ÷ 1"

# HYDROGEN **NEW**

PRODUCTS - FLOATING & TRUNNION

**vinco**  
VALVES



## **GFH6** SERIES

3-Piece Bolted  
Floating Type  
Fire Safe – Anti-static  
Bar stock / Forged  
CL3000  
DN 1/4" ÷ 1 1/2"



## **GFH7** SERIES

3-Piece Bolted  
Floating Type  
Fire Safe – Anti-static  
Bar stock / Forged  
CL4000  
DN 1/4" ÷ 1"



## **GFH8** SERIES

3-Piece Bolted  
Trunnion Type  
Fire Safe – Anti-static  
Bar stock / Forged  
CL6000  
DN 1/4" ÷ 1"WW

**SYSTEMS**





## **OVERFILL**

The overfill protection valve is an automatic system designed to provide an emergency shut off of the filling line in case of an overpressure. It can be adjusted to work in several working pressures and is suitable for most of existing tanks.



## **FIREBLOCK**

The fire block valve is an automatic system designed to provide an emergency shut off of the filling line in case of a fire. Additionally, it is equipped with a latch to allow the manual closing of the line without triggering the safety system.

**ACCESSORIES**



## ACTUATORS

Pneumatic / Electric Actuator,  
Limit Switch and Solenoid  
Valve Assembly



## FIRE FAIL SAFE

Firefail safe for automatic  
emergency shutoff in case of fire  
spread across the line process

# LOCKABLE HANDLE

PRODUCTS



## STEM EXTENSION

Stem extension for accessibility  
or isolation



## SPRING RETURN

Spring return for mechanical close  
after usage



## LOCKABLE HANDLE

Lockable handle to prevent  
unintended rotation of the obturator



vinco  
VALVES

THANK YOU

follow us